

HOLY NAME OF JESUS CHURCH

---

Building Our Tomorrow  
a Legacy of Faith

---

The Blessed Mother welcomes the  
community to Holy Name of Jesus Church.



# A Message from Our Pastor

My dear sisters and brothers in Holy Name of Jesus Parish:

We are **Building Our Tomorrow . . .** and we are leaving **A Legacy of Faith!** Today, we who are Holy Name of Jesus Church, are asked to hand down the faith that we have received from others and, in addition, a new church in which to worship, and improvements for our buildings of learning. We hope that all of us will be able to enjoy new facilities in the near future and to share them with future generations.



As you read this brochure, you will get a better sense of the past, present, and future of Holy Name of Jesus Church. No matter how long we have been members of this parish, all of us who are present now are invited to be part of the future. Give as you have been given!

When the Apostles prayed for Matthias to be numbered among the Apostles, they prayed, not that they might choose the right person, but that the Lord would make known to them the one that He had chosen. What we pray is that the Lord will reveal to us what is His will in regard to our new facilities. May God, who begins this good work in and through us, bring it to completion in Christ Jesus!

The information in this pamphlet is designed to help you understand **Building Our Tomorrow . . . A Legacy of Faith**, which is the theme that our committee chose for our campaign. This ambitious undertaking will require the support of our entire parish family, as we anticipate our dream of a new church and other improvements.

We know that God wants us to have life and have it more abundantly. He will not be outdone in generosity,

as many of you have experienced through our tithing spirituality. He repays our sacrifices many times over. Different people have commented how God has blessed them over and over again, as they have shared of their resources through “God’s Plan for Giving.”

Now is the time for us to venture out in faith and trust in God, and make a commitment to our new church. I am most impressed with the campaign’s concepts of “faith promise” and “equal sacrifice—not equal gifts.” In whatever way God has blessed us, is how we are to respond in faith and with faith! Each one’s equal sacrifice will make a new church a reality very quickly. Some have already come forward and have made their equal sacrifice, and there are many others who have stated that they are ready to do the same. Remember the key words: “faith promise” and “equal sacrifice.” What is done from a spiritual motive will bring many blessings to us individually and as Church.

Beginning with Kick-Off Weekend, we will be concluding the Prayer of the Faithful at Mass by praying together the Holy Name of Jesus Prayer. That prayer will unite us all as one as we pray for one another individually and collectively. As we conclude this prayer, I conclude this message:

“Bless this endeavor of a new church that it may be done through, with, and in Your Son, Jesus.

“May **‘Building Our Tomorrow . . . A Legacy of Faith’** guide us to this end, that many more may worship, and give you honor and glory.

“We ask this in the name that is above every name, that of the Holy Name of Jesus. Amen.”

Sincerely yours in the Lord,

A handwritten signature in black ink that reads "Robert E. Lawrence". The signature is written in a cursive, slightly slanted style.

Rev. Msgr. Robert E. Lawrence  
Pastor

# The Capital Campaign

**H**OLY NAME OF JESUS seeks to raise \$5 million to make essential improvements to existing buildings, build a new church, and begin to renovate the school.

The campaign begins at our May Kick-off Event and will wrap up in early October 2007. Every family in the parish will be contacted and asked to support the campaign.

After you make your Faith Promise, you can make your contributions over a three-year collection period. Once the campaign reaches the goal, construction will begin on the new church.

## *Building Our Tomorrow*

Imagine the new Holy Name of Jesus Church:

- + A larger church that accommodates 1,400 people
- + An energy-efficient comfortable environment
- + A facility that is up to current building codes
- + A more secure church and school
- + Better traffic flow that's safer for driving and walking
- + Improved accessibility for our parishioners with disabilities
- + A plan that is financially manageable and does not interrupt current ministries or activities



In 1960, our community joined together and founded Holy Name of Jesus Church.

## Now the Lord Calls Us

The Holy Name of Jesus Parish Mission calls us to live according to the teachings of Jesus Christ and to share His message of universal saving love with others.

We are called to educate and foster the spiritual growth of all parishioners, especially our children, and to provide facilities that meet the current and future needs of our parish and community.

## *Why Now?*

- + Aging facilities
- + 3,400 member families and growing
- + 8 weekend Masses
- + Deferred maintenance
- + Outdated security and energy technology
- + Plan to improve disconnected school with school and eliminate modulars

# Planned Use of Property

## Benefits of Plan

- † Use of current church during construction
- † Maintain current rectory
- † I-81 visibility
- † No impact on athletic fields
- † Good traffic flow and space for parking
- † Better traffic flow that allows for safer driving, walking, and play areas for our school children

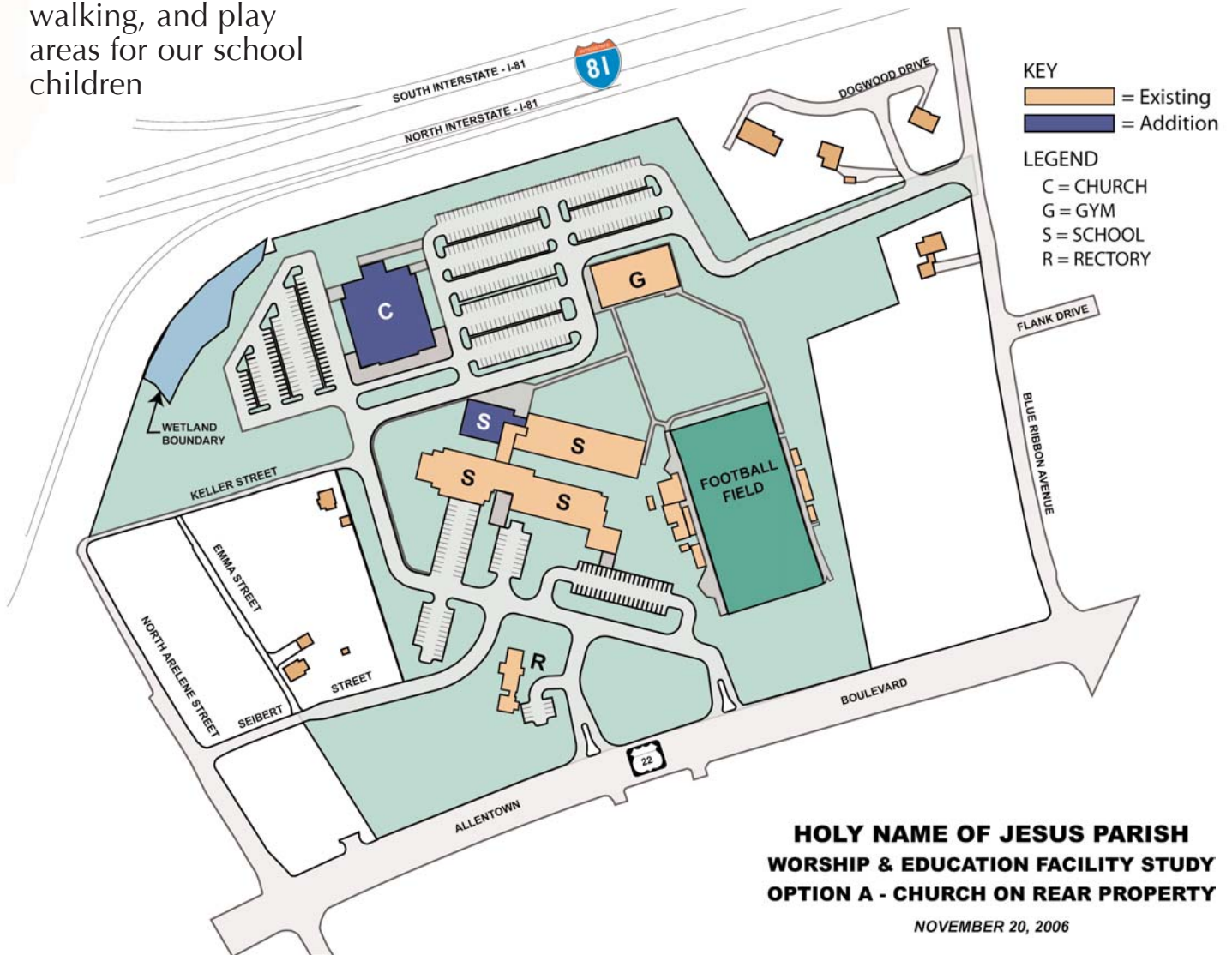

**KEY**  
= Existing  
= Addition

**LEGEND**  
C = CHURCH  
G = GYM  
S = SCHOOL  
R = RECTORY

**HOLY NAME OF JESUS PARISH  
WORSHIP & EDUCATION FACILITY STUDY  
OPTION A - CHURCH ON REAR PROPERTY**

NOVEMBER 20, 2006

# Preliminary Church Floor Plan

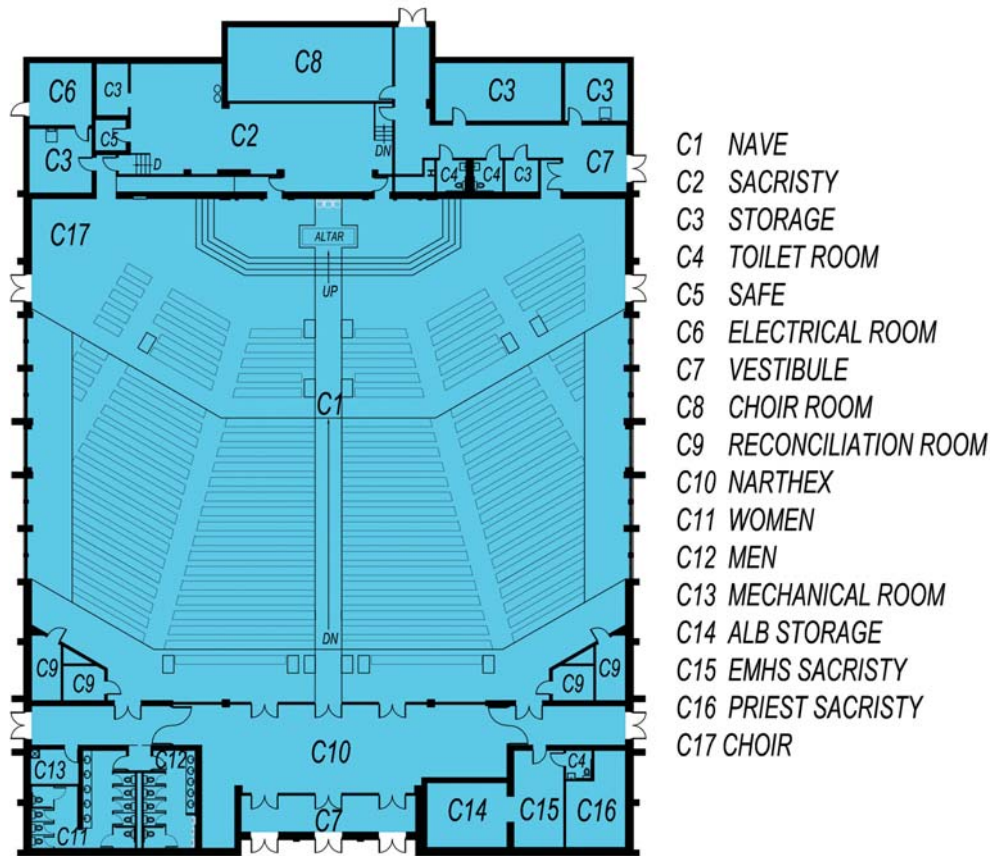

## Preliminary Features of New Church

- † Nave Seating for 1400
- † Nave floor sloping gently down to the elevated Altar platform
- † New Altar and Liturgical fixtures to reflect the scale of the larger Nave
- † Relocate statues of Jesus, Mary, and Joseph, currently located behind the Altar
- † Stained glass windows in exterior side walls with the 14 Stations of the Cross on the interior pilasters. Stained glass windows to be visible from Route 81 and the Church property
- † Cathedral ceiling sloping upward to the center of the Nave
- † Clerestory or high windows in the center of the Nave ceiling
- † Gold stenciled lettering of scriptural text under the clerestory windows at high Nave center ceiling, possibly Philippians 2:9-10
- † New bell or cross tower, with possible night lighting, for visibility to the community
- † New Sacristy, storage, and walk-in safe
- † Four Reconciliation Rooms
- † Priest & EMHS Sacristies near the front Narthex
- † Expanded men's and women's Restrooms to meet code

# We Need Your Support

**M**AKING A FAITH PROMISE COMMITMENT is a prudent, practical, and responsible form of stewardship. Nearly everyone believes in a commitment when dealing with personal financial affairs, when arranging for loans or other forms of credit, or when saving for future expenditures. Now is the time to use this same kind of reasoning and common sense to care for our combined interests as a church community. It would be impossible to raise enough money through cash donations or “gifts of convenience.” We must rely on everyone to plan a personal three-year goal and then accomplish it, one step at a time.

With the spirit of equal sacrifice—not equal gifts, our commitment relies on the spiritual values of sacrifice and faith.



## Projected Phases and Estimated Total Costs

Immediate improvement needs <i>(Already in progress)</i>	\$275,000
New Church/sitework <i>(Begins when campaign reaches goal)</i>	\$7,250,000
Church to school and renovations to lower grade <i>(Fund-raising begins when current campaign collections are completed)</i>	\$5,360,000
Renovations to School upper grade	\$2,450,000
New classroom wing	\$1,000,000
<b>Total</b>	<b>\$16,335,000</b>

### Survey of Holy Name Parishioners

Parishioners completed 1700 surveys in March 2007

68% of the active families participated in the survey

97% of surveys were supportive of investing in our church and school

## Building Our Tomorrow . . . a Legacy of Faith Commitment Guide

Yearly Household Income	3%				5%				7%			
	Weekly	Monthly	Yearly	Faith Promise	Weekly	Monthly	Yearly	Faith Promise	Weekly	Monthly	Yearly	Faith Promise
\$ 20,000	\$11.54	\$50.00	\$600	\$1,800	\$19.24	\$83.35	\$1,000	\$3,000	\$26.94	\$116.70	\$1,400	\$4,200
\$ 30,000	\$17.31	\$75.00	\$900	\$2,700	\$28.85	\$125.00	\$1,500	\$4,500	\$40.39	\$175.00	\$2,100	\$6,300
\$ 40,000	\$23.08	\$100.00	\$1,200	\$3,600	\$38.46	\$166.70	\$2,000	\$6,000	\$53.84	\$233.40	\$2,800	\$8,400
\$ 50,000	\$28.85	\$125.00	\$1,500	\$4,500	\$48.13	\$208.35	\$2,500	\$7,500	\$67.36	\$291.70	\$3,500	\$10,500
\$ 60,000	\$34.62	\$150.00	\$1,800	\$5,400	\$57.70	\$250.00	\$3,000	\$9,000	\$80.78	\$350.00	\$4,200	\$12,600
\$ 70,000	\$40.38	\$175.00	\$2,100	\$6,300	\$67.30	\$291.70	\$3,500	\$10,500	\$94.22	\$408.40	\$4,900	\$14,700
\$ 80,000	\$46.15	\$200.00	\$2,400	\$7,200	\$76.92	\$333.35	\$4,000	\$12,000	\$107.69	\$466.70	\$5,600	\$16,800
\$ 90,000	\$51.92	\$225.00	\$2,700	\$8,100	\$86.54	\$375.00	\$4,500	\$13,500	\$121.16	\$525.00	\$6,300	\$18,900
\$ 100,000	\$57.69	\$250.00	\$3,000	\$9,000	\$96.15	\$416.70	\$5,000	\$15,000	\$134.61	\$583.40	\$7,000	\$21,000
\$ 110,000	\$63.46	\$275.00	\$3,300	\$9,900	\$105.77	\$458.35	\$5,500	\$16,500	\$148.08	\$641.75	\$7,700	\$23,100
\$ 120,000	\$69.23	\$300.00	\$3,600	\$10,800	\$115.39	\$500.00	\$6,000	\$18,000	\$161.55	\$700.00	\$8,400	\$25,200

# Questions You May Be Asking

## Why has the parish hired a professional fund-raising consultant?

Holy Name of Jesus Church contacted other churches that have recently gone through major fund-raising and building programs, and we were advised that contacting and visiting church members is a very time-consuming job, requiring much organization and great demands on volunteers.

## What is the cost of the project and when will construction begin?

In order to begin construction, we need to raise 50% of the phase one costs. Our goal is to raise \$5 million in this phase. The total cost of all phases of the project will be \$16,335,000. Phase one construction will begin when we meet the goal.

## Will all member families be asked to give?

Each member family will be asked to make a sacrificial financial commitment. The total amount of your Faith Promise may be paid over a three-year period and, in most cases, is fully tax-deductible.

## How much should I give?

After prayerful consideration, you should select an amount that your family can sacrifice given your financial resources and obligations. Recommendations are included in the Faith Promise Giving Plan.

## How do I make my contribution?

You will be contacted by mail or in person. You will have the chance to ask any questions you may have about your Faith Promise. Once you make your commitment, you will receive special envelopes, which you will use to make your contributions.

## How long will the campaign last and when will my contributions begin?

The campaign will be launched at the Kick-off event on May 19, 2007 and continue through September. Contributions will begin in early October and can continue for three years.

## Can I support the campaign in other ways? How about non-monetary gifts?

Yes. Contributions of property, stock, or other tangible assets may be accepted.

## How will the project benefit the school?

The phase one construction of a new church sets the stage for making substantial improvements to the school, including elimination of the modular units, connecting the two buildings, and improving technology and security.

## Is my contribution in addition to my regular tithes and offerings?

Yes. Your contributions for this project are in addition to your regular tithes and offerings. It is important to continue your regular offering to fund ongoing parish operations.

## What was the final resolution of the WalMart project?

The church continues to pursue reimbursement from WalMart. Updates will continue in the bulletin.

## Is my "Faith Promise" a legal document? Can I change my amount?

While your Faith Promise is a promise that will be relied upon as plans for construction are finalized, your parish family would not seek to legally enforce this promise. Because you cannot always anticipate changes in your financial circumstances, you can increase or decrease your pledge accordingly.

## HOLY NAME OF JESUS PRAYER

Almighty and eternal God,  
You have invited us to come to you and ask for needs  
for ourselves and others.  
We come to you this day and ask that You listen to the  
prayers of our hearts.  
We ask Your special graces on this parish that bears  
the holy name of Your Son, Jesus.  
Guide all your people through the Holy Spirit.  
Teach us and form us according to the teaching and  
life of Your Son, Jesus, that we may do everything  
out of love for you.  
Bless our parish and all who worship with us.  
Unite and form us that we may serve You and one  
another.  
Be with our sick and touch them with Your love.  
Touch the hearts of all to accept Your forgiveness.  
Inspire all of us to follow the vocation that You have  
given us.  
Form us more and more into Your image and likeness  
that we may show You to the world.  
Bless this endeavor of a new church that it may be  
done through, with, and in Your Son, Jesus.  
May ***“Building Our Tomorrow . . . A Legacy of  
Faith”*** guide us to this end, that many more may  
worship, and give you honor and glory.  
We ask this in the name that is above every name,  
that of the Holy Name of Jesus. Amen



HOLY NAME OF JESUS CHURCH

Building Our Tomorrow  
a Legacy of Faith

6150 Allentown Boulevard  
Harrisburg, PA 17112-2603  
717-652-4211

[www.HolyNameofJesus.com](http://www.HolyNameofJesus.com)



Assisting your campaign

**Kirby Smith**  
Associates, Inc.  
*Ministry of Church Finance*

# We Need Your Support

**M**AKING A FAITH PROMISE COMMITMENT is a prudent, practical, and responsible form of stewardship. Nearly everyone believes in a commitment when dealing with personal financial affairs, when arranging for loans or other forms of credit, or when saving for future expenditures. Now is the time to use this same kind of reasoning and common sense to care for our combined interests as a church community. It would be impossible to raise enough money through cash donations or “gifts of convenience.” We must rely on everyone to plan a personal three-year goal and then accomplish it, one step at a time.

With the spirit of equal sacrifice—not equal gifts, our commitment relies on the spiritual values of sacrifice and faith.



## Projected Phases and Estimated Total Costs

Immediate improvement needs <i>(Already in progress)</i>	\$275,000
New Church/sitework <i>(Begins when campaign reaches goal)</i>	\$7,250,000
Church to school and renovations to lower grade <i>(Fund-raising begins when current campaign collections are completed)</i>	\$5,360,000
Renovations to School upper grade	\$2,450,000
New classroom wing	\$1,000,000
<b>Total</b>	<b>\$16,335,000</b>

## Survey of Holy Name Parishioners

Parishioners completed 1700 surveys in  
March 2007

68% of the active families participated in  
the survey

97% of surveys were supportive of  
investing in our church and school